

## MOUNTING PROCEDURE

KIT WINDSHIELD  
KAWASAKI Z 1000 '10 - '13

**KN1300/10**

WWW.BARRACUDAMOTO.COM

## KIT

- X1. BARRACUDA WINDSHIELD/SCREEN
- X4. RUBBER WASHERS
- X4. TEFLON WASHERS
- X2. SCREW 5X20
- X2. SCREW 5X35
- X2. PVC THICKNESS

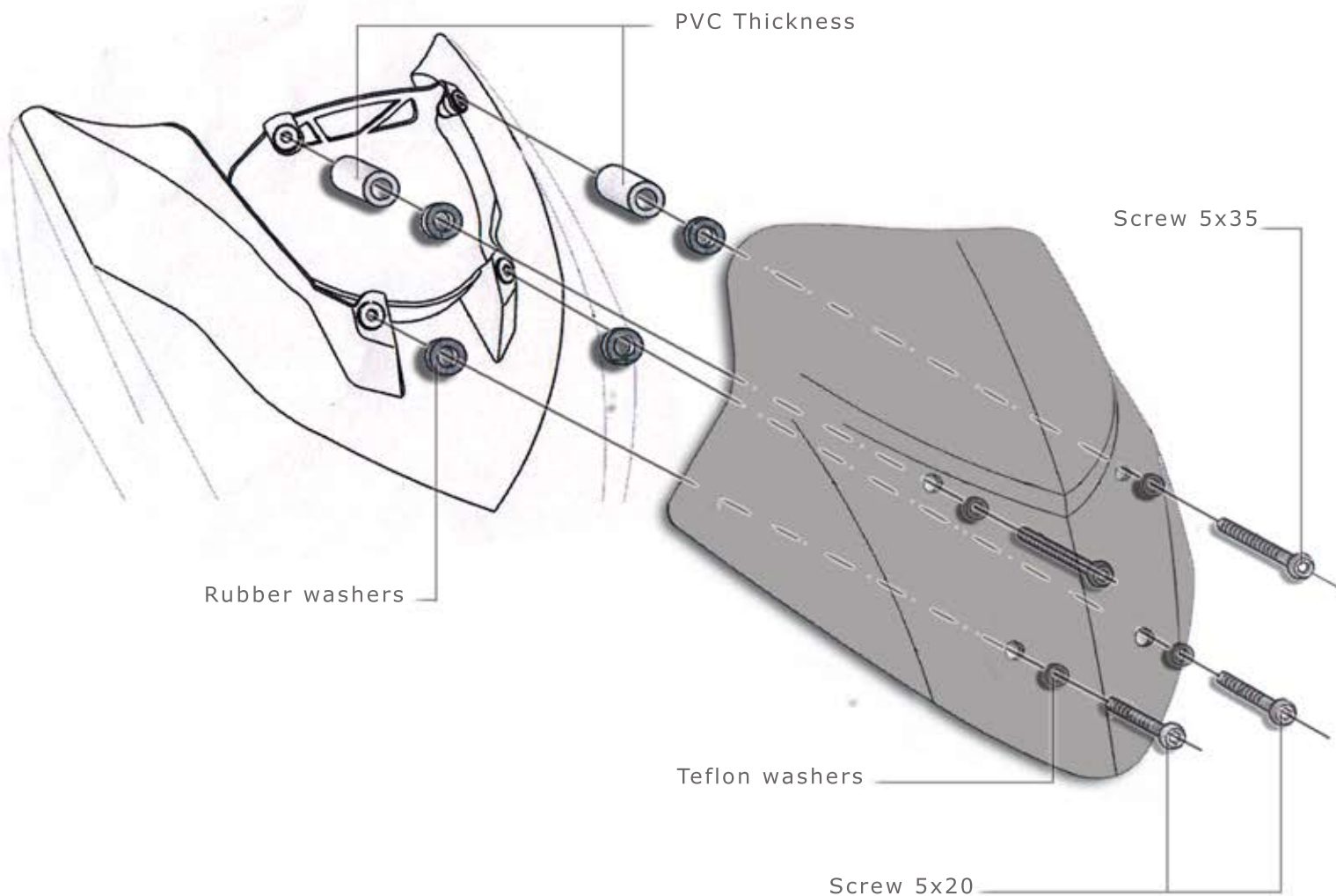

REMOVE THE ORIGINAL WINDSHIELD/SCREEN. FIX THE BARRACUDA WINDSHIELD/SCREEN USING THE SPECIFIC SCREWS LIKE THE DESCRIPTION.

USE THE PVC THICKNESS AND THE RUBBER WASHERS.

PUT THE PVC THICKNESSES INTO THE HIGHER HOLES OF WINDSHIELD/SCREEN ONLY.

USE THE TEFLON WASHERS BETWEEN THE HEAD OF SCREW AND THE WINDSHIELD/SCREEN

NOTE: DON'T LOCK TOO MUCH TO AVOID POSSIBLE PLEXIGLASS DAMAGES